

LADY LUCK

Designed by Robert Kaufman Fabrics
www.robertkaufman.com

Featuring ARTISAN FABRICS

Sunrise Blossoms L¹⁰⁰⁰



Finished quilt measures: 66" x 80"





Difficulty Rating: **Beginner**

ROBERT KAUFMAN
F A B R I C S

For questions about this pattern, please email Patterns@RobertKaufman.com.

Fabric and Supplies Needed

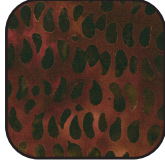
Fabric amounts based on yardage that is 42" wide.

Color	Fabric	Name/SKU	Yardage	Color	Fabric	Name/SKU	Yardage
		RU-1125-40 SUNRISE BLOSSOMS	One Roll Up		C	AMD-21628-250 LUPINE	1 yard
	A	AMD-7000-187 PLATINUM	2-3/4 yards		Binding*	AMD-21632-342 CHESTNUT <i>*Also included in the Roll Up.</i>	5/8 yard
	B	AMD-21629-16 BROWN	5/8 yard	You will also need: 5 yards for backing			

Copyright 2022, Robert Kaufman
For individual use only - Not for resale

Notes Before You Begin

- Read through all of the instructions before beginning.
- All of the seam allowances are 1/4" unless otherwise noted.
- Press seam allowances open unless otherwise noted.
- Width of fabric (WOF) is equal to at least 42" wide.
- Right sides together has been abbreviated to RST.
- Remember to measure twice and cut once!

Cutting Instructions

From the Roll Up:

Separate the Roll Up into ten sets of three strips. Sew the three strips together, lengthwise, then press the seams to one side. Cut:

six 6-1/2" squares from each sewn strip set.

Note: Eighty squares are needed to make the quilt.

From Fabric A, cut:

thirty-nine 2-1/2" x WOF strips. Subcut:

thirty-one 2-1/2" x 12-1/2" rectangles

two-hundred and forty 2-1/2" squares

From Fabric B, cut:

eight 2-1/2" x WOF strips. Subcut:

twelve 2-1/2" squares

Sew the remaining strips together end-to-end, then subcut:

two 2-1/2" x 68-1/2" inner side borders

two 2-1/2" x 58-1/2" inner top and bottom borders

From Fabric C, cut:

seven 4-1/2" x WOF strips. Sew the strips together end-to-end, then subcut:

two 4-1/2" x 72-1/2" outer side borders

two 4-1/2" x 66-1/2" outer top and bottom borders

From the Binding Fabric, cut:

eight 2-1/2" x WOF strips

Assemble the Blocks

Step 1: Place a 2-1/2" Fabric A square on three corners of a 6-1/2" strip square, RST. Mark a diagonal line on each 2-1/2" square. Sew on the marked lines, then trim the excess fabric 1/4" away from the seams. Make eighty snowballed units.

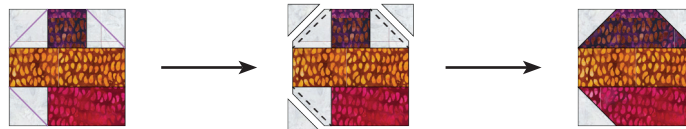

Step 2: Sew four snowballed units together following the Block Assembly Diagram. Make twenty blocks.



Assemble the Horizontal Sashing Strips

Step 3: Sew four 2-1/2" x 12-1/2" Fabric A strips and three 2-1/2" Fabric B squares together as shown. Press the seams towards the sashing rectangles. Make four horizontal sashing strips.



Assemble the Quilt

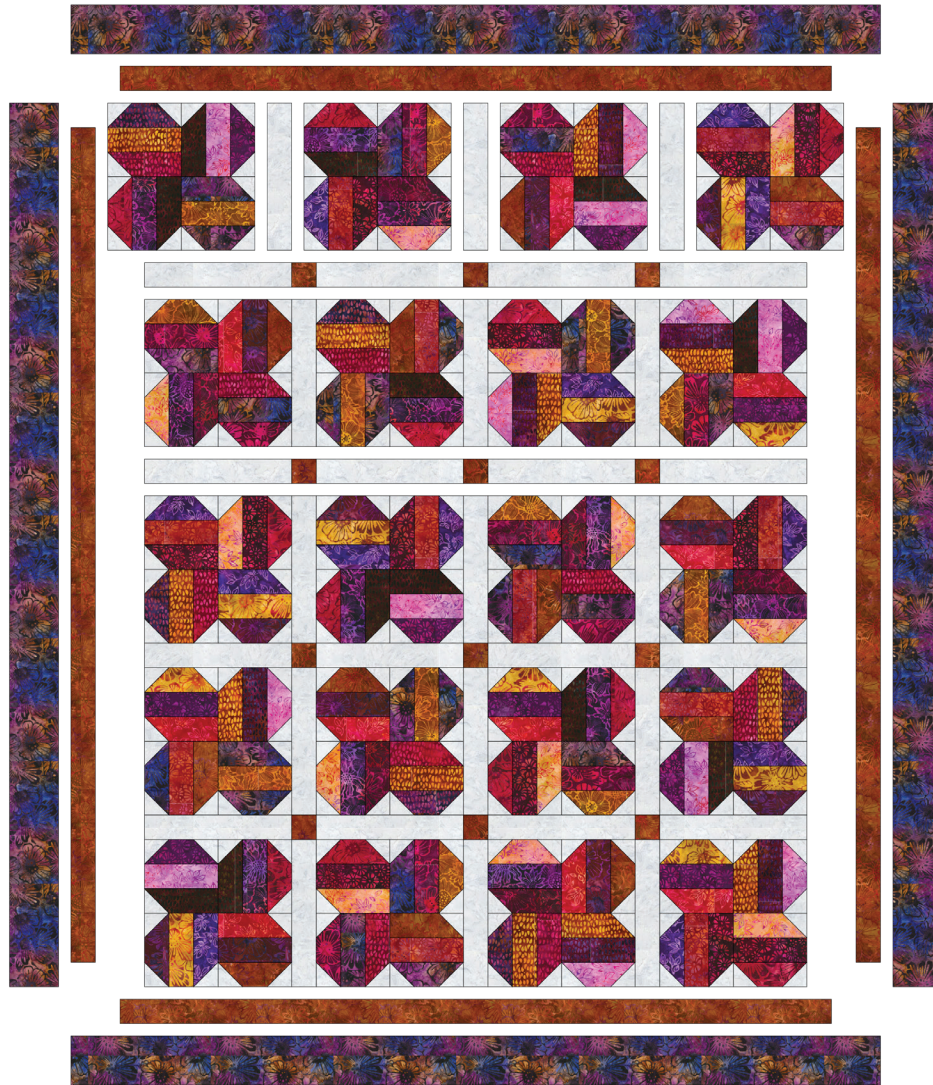

Step 4: Arrange the blocks in five rows of four blocks. Place a 2-1/2" x 12-1/2" Fabric A strip in between each block. Sew the blocks and sashing strips together to form a row. Press the seams towards the sashing rectangles. Repeat for each row.

Step 5: Place a horizontal sashing strip between each row. Sew the rows and horizontal sashing strips together to form the quilt center. Press open or towards the sashing strips.

Step 6: Sew a 2-1/2" x 68-1/2" inner side border to both sides of the quilt. Press towards the borders. Sew a 2-1/2" x 58-1/2" inner side top and bottom border to the top and bottom of the quilt top. Press towards the border.

Step 7: Sew a 4-1/2" x 72-1/2" outer side border to both sides of the quilt. Press towards the borders. Sew a 4-1/2" x 66-1/2" outer top and bottom border to the top and bottom of the quilt top. Press towards the border.

Your quilt top is now complete. Baste, bind, quilt, and enjoy!

This pattern may be used for personal purposes only and may not be reproduced in any form without the express permission from Robert Kaufman Fabrics. This pattern is not for resale. All patterns, unless otherwise attributed, are © Robert Kaufman Co., Inc. 2005-2022. All rights reserved.